

CAMERA HOUSING

TP-602/602A/605/606/607



TP-602



TP-602A



TP-605



TP-606



TP-607

FEATURES

TP-602/602A

- ◆ INDOOR HOUSING
- ◆ COST EFFECTIVE
- ◆ EASY TO INSTALL AND MAINTAIN
- ◆ REAR LINK-LOCK LATCH
- ◆ SMALL SIZE
- ◆ FANCY DESIGN

TP-605/606/607

- ◆ COST EFFECTIVE
- ◆ OUTDOOR HOUSING
- ◆ DIE-CAST ALUMINIUM ALLOY CONSTRUCTION
- ◆ EASY TO INSTALL AND MAINTAIN
- ◆ ADDITIONALLY INSTALL HEATER AND BLOWER
AVAILABLE (FOR TP-606 AND TP-607)

DIMENSION

Unit: mm

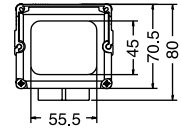
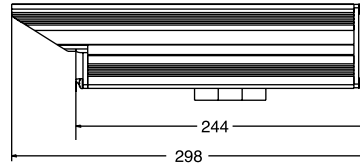
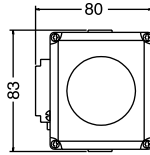
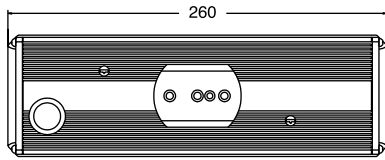
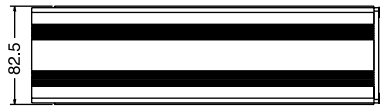
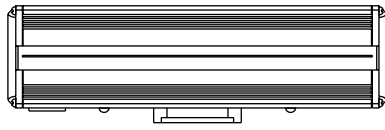

● TP-602

● TP-602A

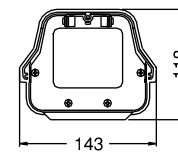
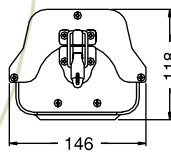

● TP-605

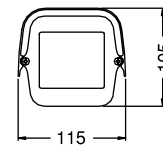
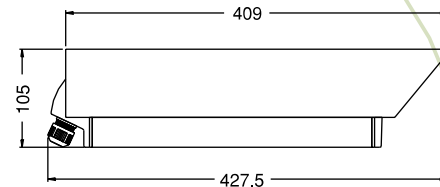
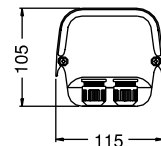

● TP-606

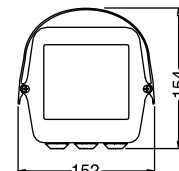
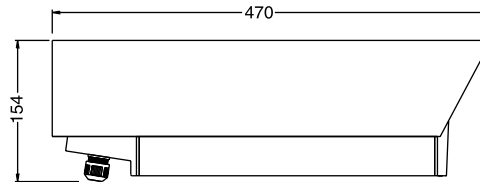
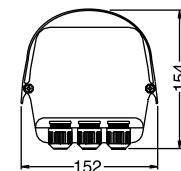

● TP-607

SPECIFICATION

| | | |
|--------------------------|---------------|-------------------|
| MODEL | TP-602 | TP-602A |
| DIMENSION (L X W X H) mm | 260 X 83 X 80 | 260/298 X 80 X 70 |
| WEIGHT | 670g | 697g |
| MATERIAL | ALUMINIUM | |
| CONSTRUCTION | | SUNSHIELD |

| | | | |
|--------------------------|-----------------|-----------------|-----------------|
| MODEL | TP-605 | TP-606 | TP-607 |
| DIMENSION (L X W X H) mm | 411 X 146 X 118 | 409 X 115 X 105 | 470 X 152 X 154 |
| WEIGHT | 1474g | 1860g | 2752g |
| MATERIAL | ALUMINIUM | | |

TP-606H: TP606 + HEATER

TP-606B: TP606 + BLOWER

TP-606HB: TP606 + HEATER+BLOWER

TP-607H: TP607 + HEATER (AC 24V/110V/220V)

TP-607B: TP607 + BLOWER (AC 24V)

TP-607HB: TP607 + HEATER+BLOWER(AC 24V)